

⑰ INDENTED HEAD MARKING MAXIMUM DEPTH .010.
MANUFACTURER'S TRADEMARK PER SPEC 363.
THE NUMBER(S) FOLLOWING THE TRADEMARK
INDICATES FIRST DASH NUMBER.
ARRANGEMENT OPTIONAL.

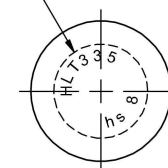

PR1436G SEALANT
(FOR "HG" CODE ONLY)

.10 MAX
OVERSPRAY

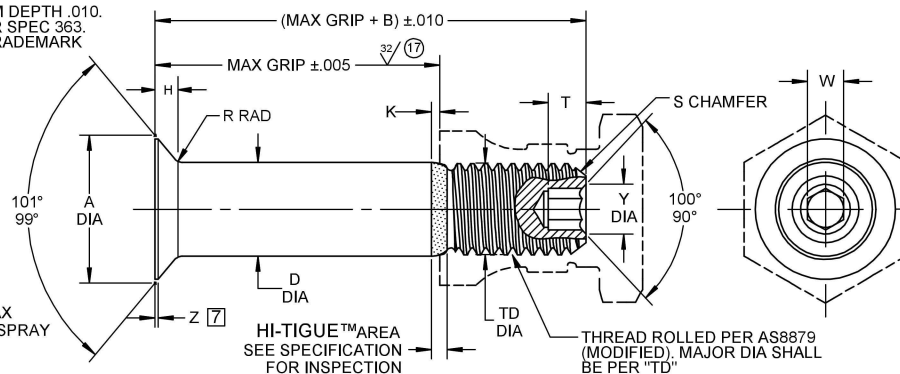

HI-LOK™ HI-TIGUE™ PIN

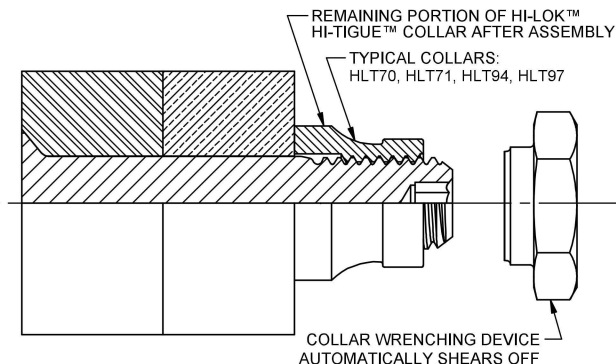

HI-LOK™ HI-TIGUE™ PIN AND COLLAR AFTER ASSEMBLY

FIRST DASH NO.	PIN NOM DIA	A DIA	B REF	D DIA		TD DIA	F	H	K REF	R RAD	Z MAX	S CHAMFER REF	THREAD MODIFIED	SOCKET			DOUBLE SHEAR POUNDS MINIMUM	TENSION POUNDS MINIMUM
				WITHOUT COATING OR SOLID FILM LUBE	AFTER COATING OR SOLID FILM LUBE									W HEX	T DEPTH	Y DIA		
4	1/8	.2219 .2171	.294	.1375 .1370	.1375 .1365	.1335 .1310	.003	.0354 .0334	.010	.020 .010	.010	1/32 x 37°	.1380-32 UNJC-3A	.0645 .0635	.100 .080	.090 .075	2,840	950
5	5/32	.2612 .2564	.312	.1640 .1635	.1640 .1630	.1595 .1570	.004	.0408 .0388	.013	.025 .015	.010	1/32 x 37°	.1640-32 UNJC-3A	.0645 .0635	.100 .080	.090 .075	4,010	1,290
6	3/16	.3016 .2966	.325	.1895 .1890	.1895 .1885	.1840 .1810	.005	.0470 .0449	.016	.030 .020	.015	1/32 x 37°	.1900-32 UNJF-3A	.0806 .0791	.100 .080	.119 .104	5,380	2,000
8	1/4	.3948 .3898	.395	.2495 .2490	.2495 .2485	.2440 .2410	.006	.0610 .0589	.021	.030 .020	.015	1/32 x 37°	.2500-28 UNJF-3A	.0967 .0947	.110 .090	.142 .122	9,300	3,700
10	5/16	.4739 .4689	.500	.3120 .3115	.3120 .3110	.3060 .3020	.007	.0679 .0658	.026	.040 .030	.015	3/64 x 37°	.3125-24 UNJF-3A	.1295 .1270	.130 .110	.180 .160	14,600	5,000
12	3/8	.5604 .5554	.545	.3745 .3740	.3745 .3735	.3680 .3640	.008	.0780 .0759	.030	.040 .030	.015	3/64 x 37°	.3750-24 UNJF-3A	.1617 .1582	.160 .140	.217 .197	21,000	7,200
14	7/16	.6680 .6620	.635	.4370 .4365	.4370 .4360	.4310 .4260	.009	.0969 .0944	.035	.050 .040	.022	3/64 x 37°	.4375-20 UNJF-3A	.1930 .1895	.190 .170	.253 .233	28,600	10,000
16	1/2	.7540 .7480	.685	.4995 .4990	.4995 .4985	.4930 .4880	.010	.1068 .1043	.039	.050 .040	.022	3/64 x 37°	.5000-20 UNJF-3A	.2242 .2207	.220 .200	.289 .269	37,300	13,500
18	9/16	.8380 .8310	.770	.5615 .5610	.5615 .5605	.5550 .5500	.010	.1160 .1130	.039	.050 .040	.022	1/16 x 37°	.5625-18 UNJF-3A	.2555 .2520	.260 .240	.326 .306	47,200	17,000

SEE COLLAR STANDARDS
FOR COLLAR STRENGTHS.
LOWER STRENGTH (PIN OR
COLLAR) DETERMINES
SYSTEM STRENGTH

HLT335

"HI-LOK", "HI-TIGUE", AND "HI-KOTE",
ARE TRADEMARKS OF HI-SHEAR CORPORATION

DRAWN BY
VAN

DATE
1969-02-12

APPROVED
MILLER

DATE
1969-02-17

REVISION
⑰

DATE
Kevin Pham
2022-04-07

TITLE
HI-LOK™ HI-TIGUE™ PIN
100° FLUSH SHEAR HEAD
TITANIUM
1/16 GRIP VARIATION

DRAWING NUMBER
HLT335

1 OF 2

- GENERAL NOTES:**
- 1 Head edge out of roundness shall not exceed "F".
 2. Concentricity: Conical surface of head to "D" diameter within .005 FIR.
 3. "H" is dimensioned from maximum "D" diameter.
 4. Surface texture per ASME B46.1.
 5. Dimensions are in inches and to be met after finish.
 6. Hole preparation per NAS618.
 - 7 Curved or flat edge manufacturer's option.
 - 8 Maximum "D" diameter may be increased by .0002 to allow for aluminum coating application.
 9. Use HLT435 for oversize replacement.
 - 10 After February, 21st of 2015, HI-KOTE™ 1 aluminum pigmented coating per Hi-Shear Spec. 294 will be replaced by REACH compliant HI-KOTE™ 1 NC aluminum pigmented coating per Hi-Shear Spec. 294 on fasteners coated in UK and European Union.

MATERIAL: 6Al-4V titanium alloy per AMS4928 or AMS4967.

HEAT TREAT: 95,000 psi shear minimum.

- 17 **FINISH:** HLT335-()-() = Cetyl alcohol lube per Hi-Shear Spec. 305.
- 17 10 HLT335AP()-() = HI-KOTE™ 1 or HI-KOTE™ 1 NC aluminum pigmented coating per Hi-Shear Spec. 294 and cetyl alcohol lube per Hi-Shear Spec. 305.
- HLT335BJ()-() = I.V.D. aluminum coating per MIL-DTL-83488, Type II, Class 3, and cetyl alcohol lube per Hi-Shear Spec. 305.
- HLT335HG()-() = I.V.D. aluminum coating per MIL-DTL-83488, Type II, Class 3, and apply precoat No. PR1436G sealant (.002-.005 thick), and cetyl alcohol lube per Hi-Shear Spec. 305.
- 17 HLT335TA()-() = Ti-Shield III or Tiodize Type II, HI-KOTE™ 2 solid film lube per Hi-Shear Spec. 292 and cetyl alcohol lube per Hi-Shear Spec. 305.
- HLT335TB()-() = HI-KOTE™ 2 solid film lube per Hi-Shear Spec.292, and cetyl alcohol lube per Hi-Shear Spec. 305.
- HLT335HK()-() = HI-KOTE™ 4 NC aluminum coating per Hi-Shear Spec. 397.

SPECIFICATION: HI-LOK™ HI-TIGUE™ Product Specification 342 .

CODE: First dash number indicates nominal diameter in 1/32nds.
 Second dash number indicates maximum grip in 1/16ths.
 See Finish note for explanation of code letters.

HOW TO ORDER

EXAMPLE: Pin Part Number
 HLT335TB8-8

Pin Basic Part Number
 8/16 or 1/2 Maximum Grip Length
 8/32 or 1/4 Nominal Diameter Pin
 Finish Code

HLT335

DRAWING NUMBER

HLT335

2 OF 2