



Tour Gamma A
193, rue de Bercy
75582 PARIS CEDEX 12
Phone 33 (0)1 44 67 85 85
Fax 33 (0)1 44 67 88 76

NUT, BIHEXAGONAL, SELF-LOCKING **A286 class 1550 MPA** **T°CRYOGENIC TO 485°C**

BA1230

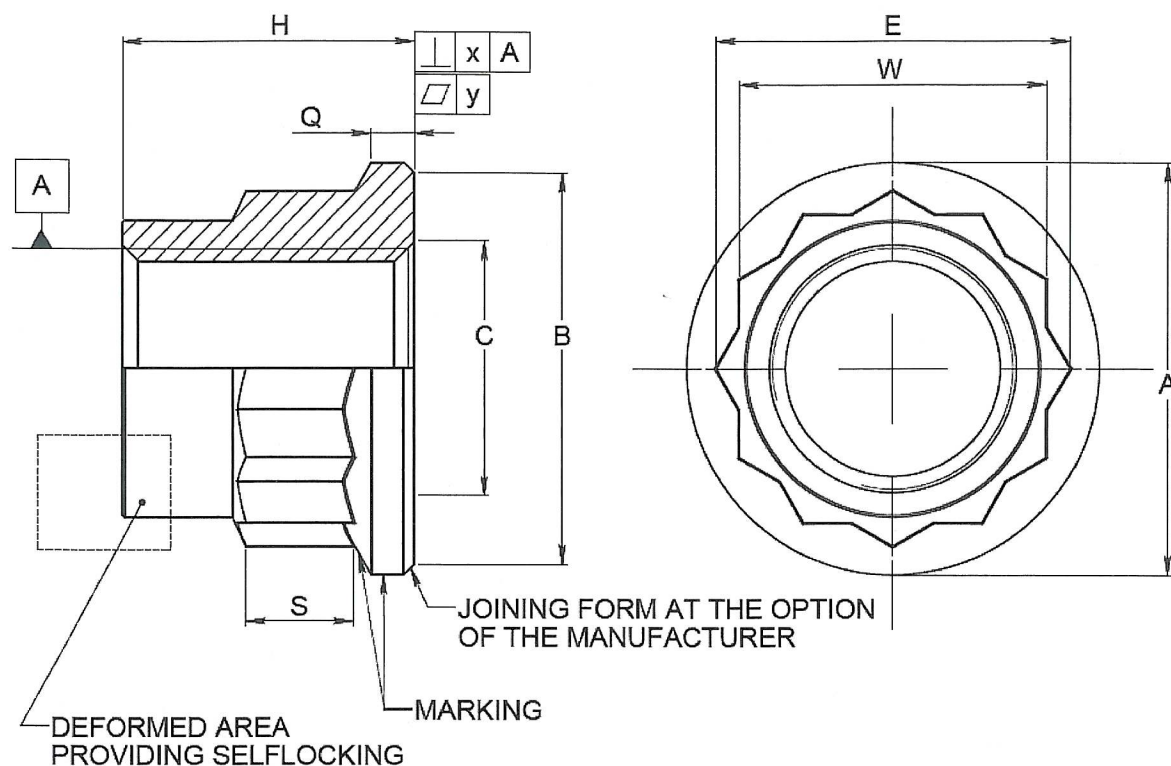

FIGURE 1



GENERAL NOTE:

UNLESS OTHERWISE SPECIFIED ON DRAWING

- i) **Units:** Dimensions and tolerance are in millimeters. Dimension to be met before lubrication
- ii) **Surface Texture :** $R_a 3.2 \sqrt{\text{ }}$ per ASME B46.1 Values to be met after Coating or Plating
- iii) **Break sharp edges:** 0.05mm/0.2mm. Nut shall be free from blur and slivers.
- iv) **Fillets :** R 0.2mm / 0.4mm
- v) **Thread:** Per AMS8879
- vi) **Tolerance:** $\pm 0.2 \text{ mm}$ and $\pm 2^\circ$

THIS DRAWING AND ALL TECHNICAL INFORMATION DISCLOSED THEREIN ARE THE EXCLUSIVE PROPERTY OF LISI AEROSPACE

Technical Center	Drawn by	Signature	Date	Approved by	Signature	Date	Revision
PAGE 1/3	R. LEMERCIER		04 OCT 2007	F. VERDIER		04 oct 07	D



Tour Gamma A
193, rue de Bercy
75582 PARIS CEDEX 12
Phone 33 (0)1 44 67 85 85
Fax 33 (0)1 44 67 88 76

NUT, BIHEXAGONAL, SELF-LOCKING **A286 class 1550 MPa** **T°CRYOGENIC TO 485°C**

BA1230

1. Nut definition

Configuration- Dimensions- Tolerances- Masses

See figure 1 and table 1

TABLE 1 : DIMENSIONS, NOMINAL SIZE

DIA DASH NO.	Threads per AMS8879	A +0,00 -0,25	B MIN	C ± 0,25	E MIN	H + 0,00 -0,40	Q + 0,50 -0,00	S MIN	W	x	y	Tensile strength (daN)	Mass kg/100pcs REF
3	10-32UNJF-3B	8,89	7,29	5,34	7,04	6,35	0,38	1,8	6,38-6,17	0,05	0,05	2200	0,10
4	1/4-28UNJF-3B	11,13	10,11	6,86	8,81	8,10	0,51	2,3	7,95-7,75	0,05	0,05	3900	0,25
5	5/16-24UNJF-3B	13,49	12,47	8,46	10,64	9,78	0,89	3,0	9,55-9,32	0,05	0,05	6300	0,45
6	3/8-24UNJF-3B	16,48	15,47	10,04	12,47	11,56	1,52	3,8	11,15-10,92	0,05	0,05	9300	1,00
7	7/16-20UNJF-3B	19,05	17,91	11,76	16,03	13,21	1,78	4,2	14,33-14,05	0,08	0,08	12600	1,40
8	1/2-20UNJF-3B	21,03	19,89	13,34	17,86	15,24	2,03	4,8	15,93-15,65	0,08	0,08	16800	2,00
9	9/16-18UNJF-3B	23,83	22,68	14,91	19,68	16,51	2,03	5,8	17,53-17,25	0,08	0,08	21300	3,10
10	5/8-18UNJF-3B	26,67	25,53	16,51	21,49	18,8	2,29	6,3	19,10-18,82	0,10	0,10	26700	4,10
12	3/4-18UNJF-3B	31,24	30,10	19,69	26,90	22,86	2,79	7,8	23,88-23,57	0,10	0,10	38700	6,50

Material

CRES A286 to the Chemistry of AMS5737

Surface Treatment

CODE E : Silverplating per AMS2410

CODE G : Molybdenum disulfide coating per AMS1701 class VI

Service Temperature Limit

Min : -196°C

Max : 485°C

2. Designation

Example: Nut BA1230 E - 7

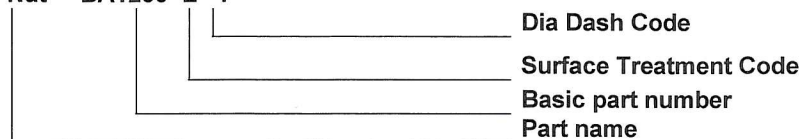

3. Marking

DIA CODE 3-4 per EN2424 style G and manufacturer monogram on nut

DIA CODE 5-12 per EN2424 style A

4. Technical Specification

-TENSILE STRENGTH BASED ON A 1550 MPa CLASS ASSEMBLY.

-NASM 25027 except for :

-Reuse test : CODE "G" limited to 5 reuse cycles only.

5. Installation Specification

-

Technical
Center

Revision



Tour Gamma A
193, rue de Bercy
75582 PARIS CEDEX 12
Phone 33 (0)1 44 67 85 85
Fax 33 (0)1 44 67 88 76

NUT, BIHEXAGONAL, SELF-LOCKING
A286 class 1550 MPA
T°CRYOGENIC TO 485°C

BA1230

Revision Date	Name	Modifications	Justification									
A 22/01/1998	-	New document										
B 23/02/1998	-	New standard form Material code changed by finish code Note 3 added										
C 31/03/1998	-	Dimension H, Q, S, Y modified. Note 4 added										
D 28/09/2007	R.LEMERCIER	<div>New standard form New finish added : "G" MoS₂ coating Added : "TENSILE STRENGHT BASED ON A 1550 MPa class ASSEMBLY." Dimensions modified for automatic extrusion : they were</div> <table><tr><td>DIA CODE</td><td>H</td><td>S min</td></tr><tr><td>-3</td><td>5.84</td><td>2</td></tr><tr><td>-4</td><td>7.62</td><td>2.5</td></tr></table> <div>Marking was : manufacturer monogram on nut</div>	DIA CODE	H	S min	-3	5.84	2	-4	7.62	2.5	
DIA CODE	H	S min										
-3	5.84	2										
-4	7.62	2.5										

Technical
Center

Revision